

Truth Hardware realizes that each profile in the marketplace may require its own particular hardware component due to the variety of mounting applications options. Because of this, Truth has developed a wide variety of unique mounting hardware choices for use in Aluminum, Vinyl, and Wood sliding patio doors. In addition to Truth's keepers, spacers and adapters, our Mortise Locks work with many of the fine line of patio door handle-sets that we offer. The attributes of these mortise locks are as follows:

- Additional Security:
 - Heat treated laminated steel bolt will withstand forced entry loads in excess of 1000 lbs.
 - Hook bolt has an "anti-slam" feature that will retract the bolt if the door is closed with the bolt extended. This feature will prevent accidental lock-outs, and damage to the door, lock, and keeper.
 - These Mortise Locks meet AAMA and CMBSO standards for sliding patio doors.
- Activation:
 - The adjustable reach hook bolt is actuated by a 90 degree rotation of the hub, and will adjust to allow easier installations on applications requiring a longer reach.
 - #32435 and 32461 Series - adjusts from .040" to .310"
 - #32436 and 32439 Series - adjusts from .140" to .420"

The #32436/32439 Series Mortise Lock has a backset of .150" that permits mounting through a metal reinforced vinyl wall section. The deeper backset allows for the face of the lock to project through and be flush with the face of the stile.

MATERIAL & FINISHES:

Keepers, adapters and spacers made of extruded aluminum alloy #6061 unless otherwise specified. Mortise locks made of an all steel case and mechanism (except the cast Zamac Zinc hub). They also feature a heat treated laminated steel bolt. The steel parts are available in clear or yellow zinc plated versions. Truth's extended reach #2320 Series (#32439) also comes in stainless steel.

WARRANTY:

Protected under the terms of the Truth Warranty for Window and Door Manufactures and Authorized Distributors. Refer to Truth's Terms & Conditions for further details.

ORDERING INFORMATION:

Because of the variety of sliding patio door designs on the market, Truth Hardware suggests that you contact our Product Specialists to help you identify the components that will best meet your requirements. These components can include mortise locks, keepers, adapters and spacers.

To assist us in helping you identify the product that you need, please be prepared to provide Truth with the type and style of profile that you are mounting the hardware to.

For Mortise Lock applications please specify Truth's model number for the mortise lock that you are interested in.

Standard Mortise Lock

- #32435 - Radiused Faceplate with 90° Hub is part #2300-1061 (clear zinc plated)
- #32436 - Radiused Faceplate with 90° Hub is part #2300-1063 (yellow zinc plated)

Series Extended Reach Mortise Lock

- #32461 - Zinc plated steel part with 90° Hub is #2320-1061
- #32439 - Stainless Steel part with 90° Hub is #2320-10SS

TRUTH TIPS:

1. A Truth Hardware Secondary Patio Door Lock or Limiter can be added for applications requiring additional security.
2. A variety of lock adapter plates and keepers available for single-point mortise latch applications to address special needs. Not all of these items are shown in the catalog. Please contact Truth's Technical Service Department for assistance.
3. The use of optional latch mounting adapters on single-point mortise latch applications will increase the forced entry rating of the door by securing the handle mounting screws into the mortise latch mounting.
4. Bumper guards (Truth item number 22082.XX), to keep door sash from contacting the opposite jamb during its travel, are highly recommended (see Handleset Accessories section).
5. If hardware shown cannot be fitted to the door because of door/hardware interference, contact Truth for other available options.
6. Installation of longer screws into the keeper rail will increase security. Screws long enough to reach the rough opening frame are recommended.
7. For easy correction of out of square or racked door installations, the use of Jamb Jack (frame adjusters) are recommended. Frame adjustment can improve both weather seal tightness and door operation over the life of the door.
8. For vinyl applications, mounting screws should pass through two PVC walls or one PVC wall and one insert wall. For this reason, it may be necessary to use a longer screw than is recommended.

FIG. 1 32435 & 32461 MORTISE LOCK

32435 - CLEAR CHROMATE PLATING
32461 - YELLOW CHROMATE

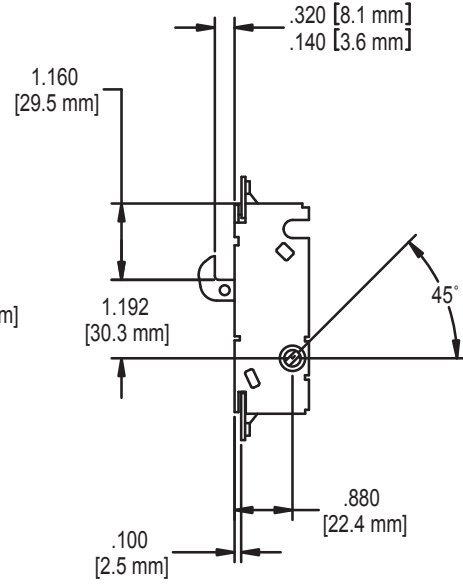
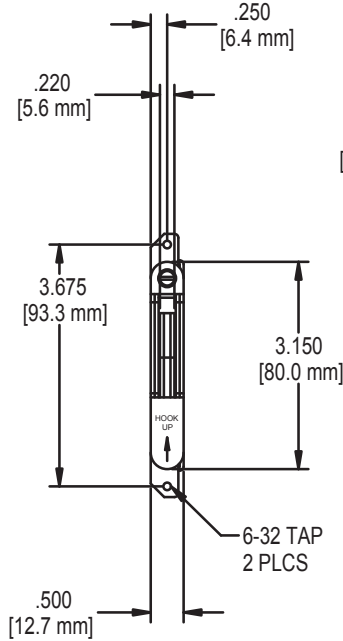
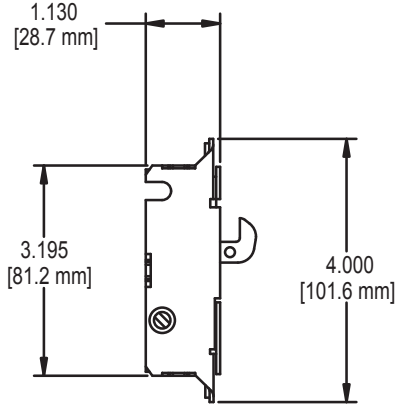

AVAILABLE ADAPTORS
31823
32413
22094

MOUNTING SCREWS: (QTY 2) (P/N 19609.61) #6-32 X 1/2"
PHILLIPS FLAT HEAD MACHINE SCREW

FIG. 2 32436 & 32439 MORTISE LOCK

32436 - CLEAR CHROMATE PLATING
32439 - STAINLESS STEEL

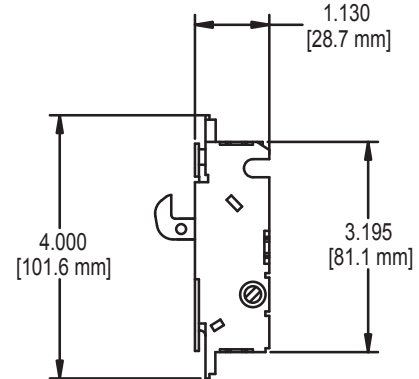
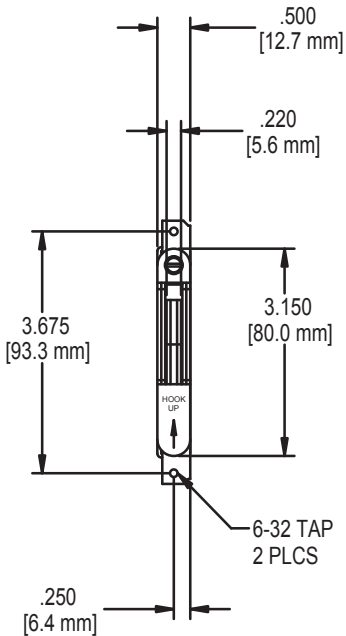
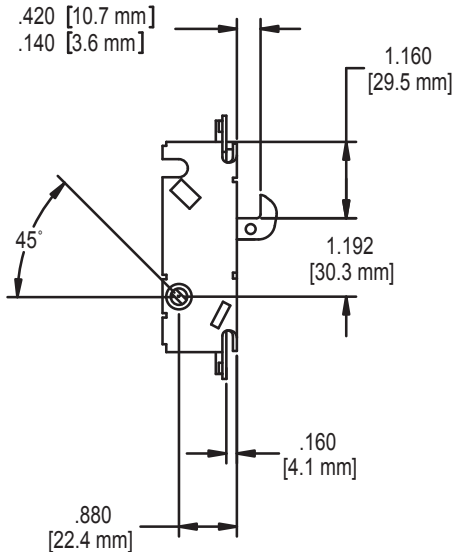

AVAILABLE ADAPTORS
31823
32413
22094

MOUNTING SCREWS: (QTY 2) (P/N 19609.61) #6-32 X 1/2"
PHILLIPS FLAT HEAD MACHINE SCREW

FIG. 3 31823 ADAPTOR

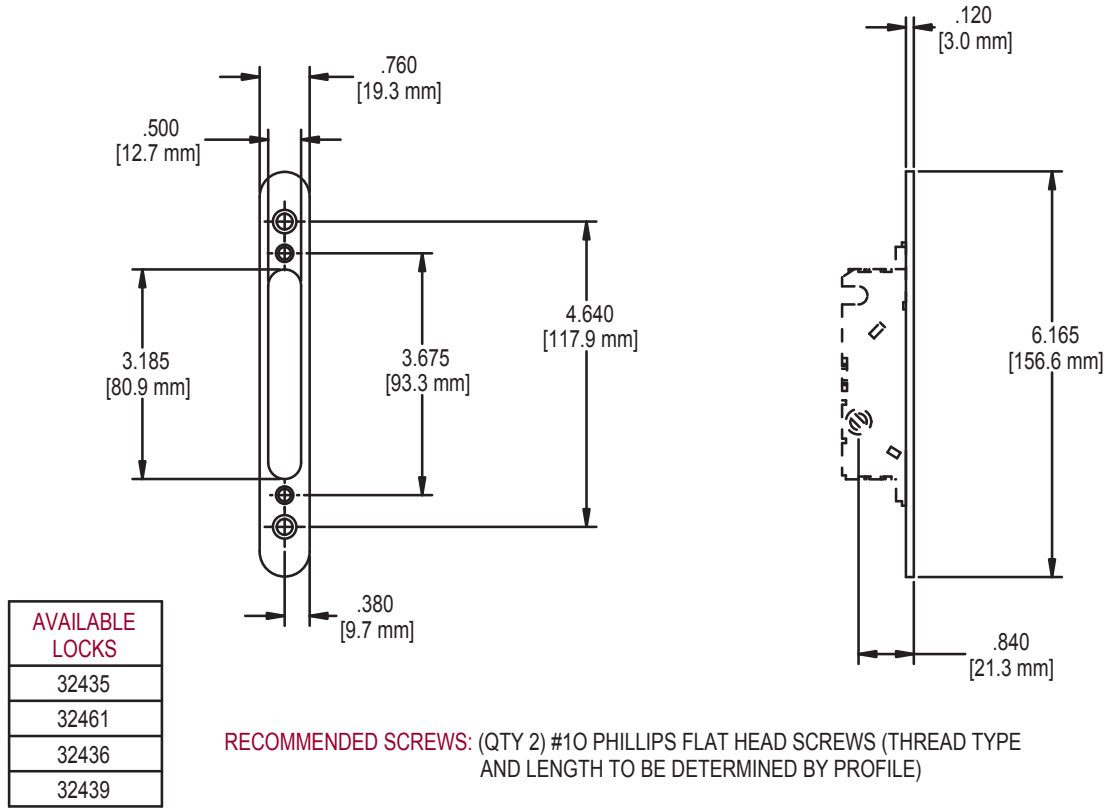

FIG. 4 22094 ADAPTOR

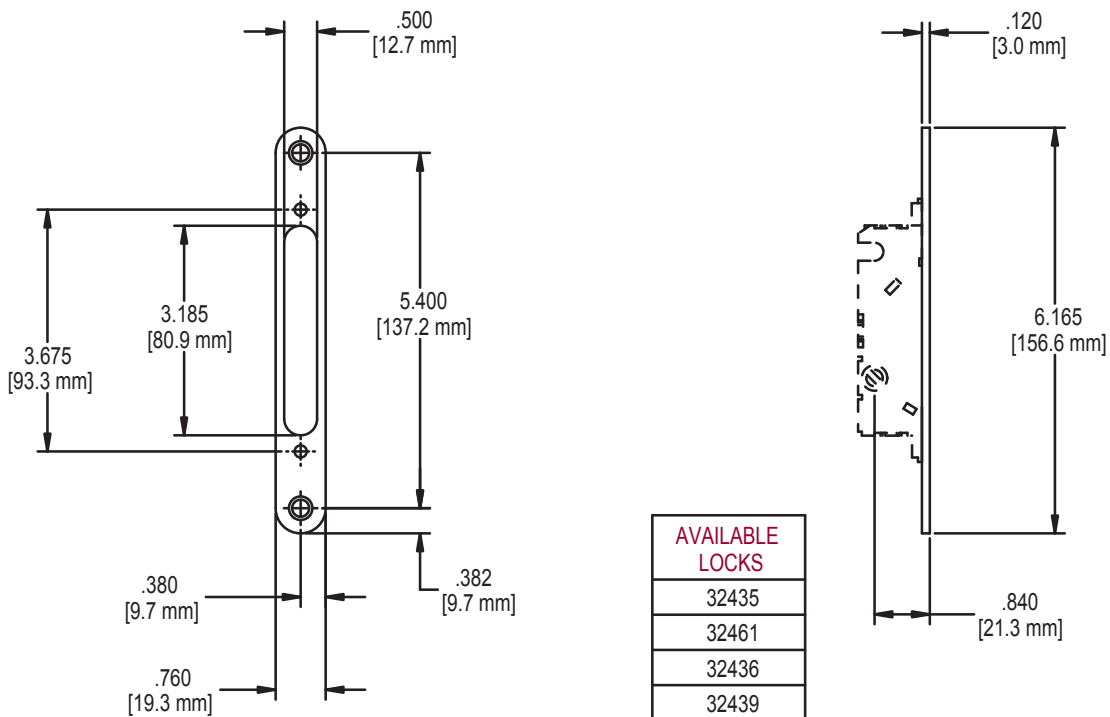

FIG. 5 32413 POCKET ADAPTOR

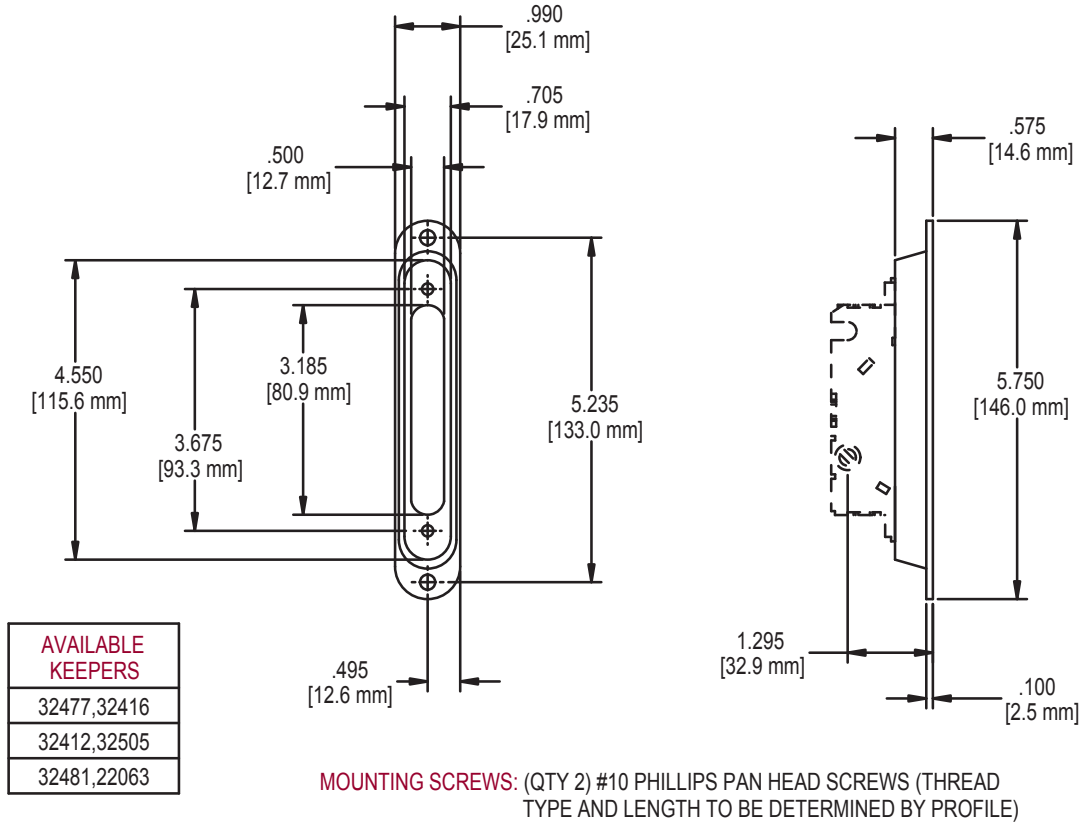

FIG. 6 2537 KEEPER

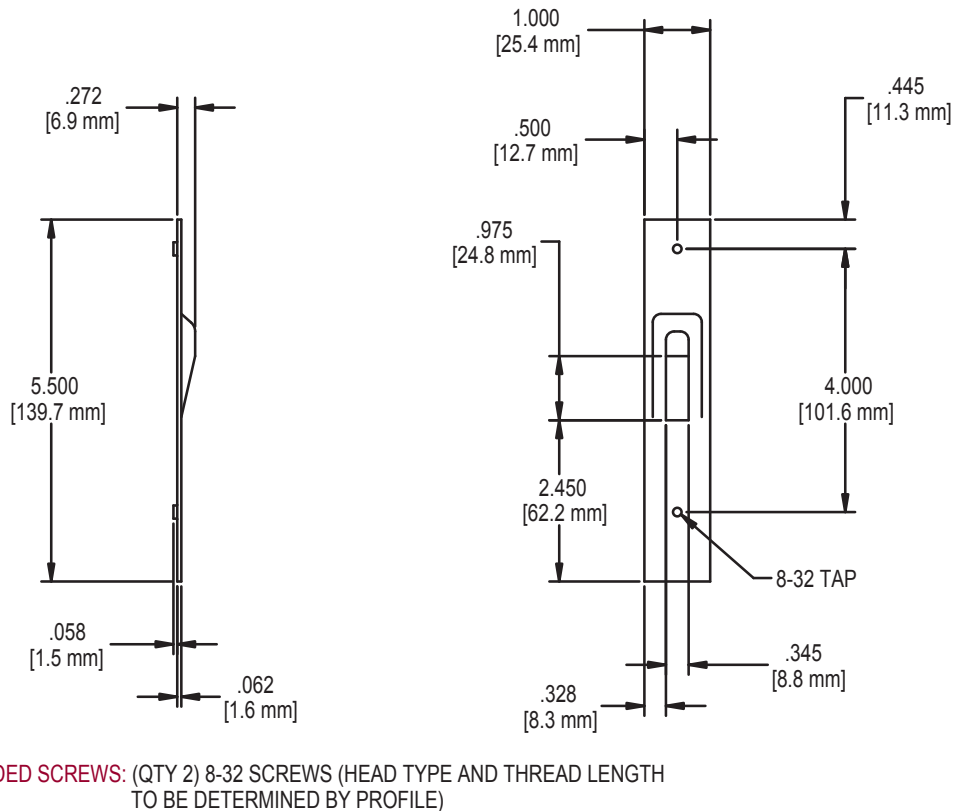
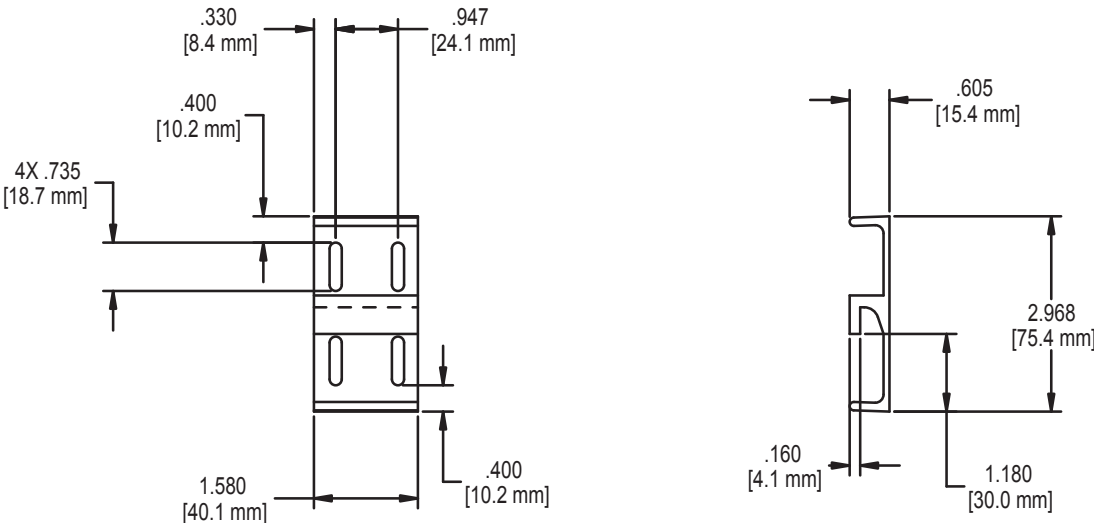
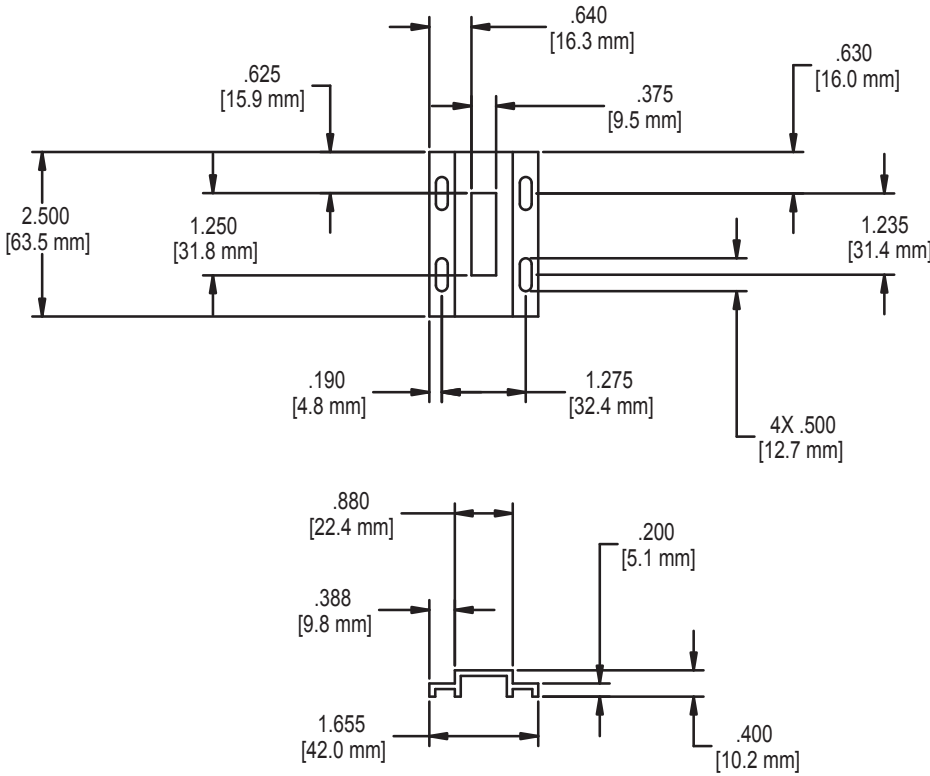

FIG. 7 22096.XX KEEPER



RECOMMENDED SCREWS: (QTY 4) #10 PHILLIPS PAN HEAD SCREWS
(THREAD TYPE AND LENGTH TO BE DETERMINED BY
PROFILE)

FIG. 8 32470.XX KEEPER



RECOMMENDED SCREWS: (QTY 4) #10 PHILLIPS PAN HEAD SCREWS
(THREAD TYPE AND LENGTH TO BE DETERMINED BY
PROFILE)

FIG. 9 2534 KEEPER

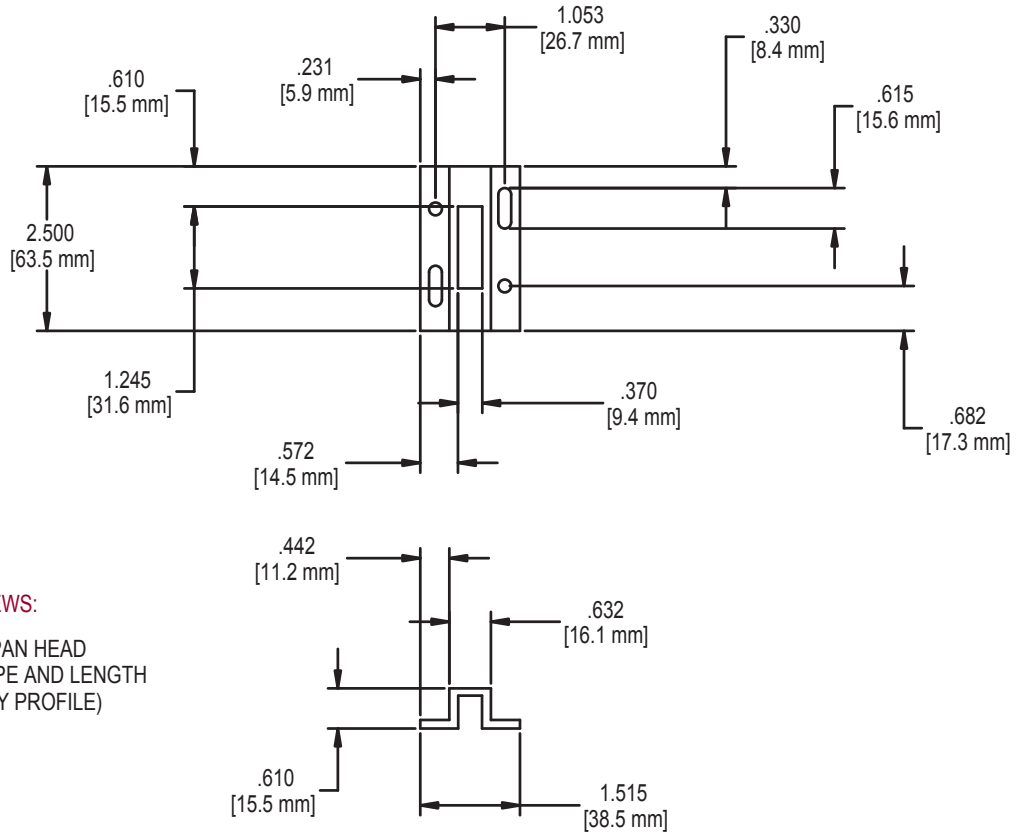

RECOMMENDED SCREWS:

(QTY 4) #10 PHILLIPS PAN HEAD
SCREWS (THREAD TYPE AND LENGTH
TO BE DETERMINED BY PROFILE)

FIG. 10 2539 KEEPER

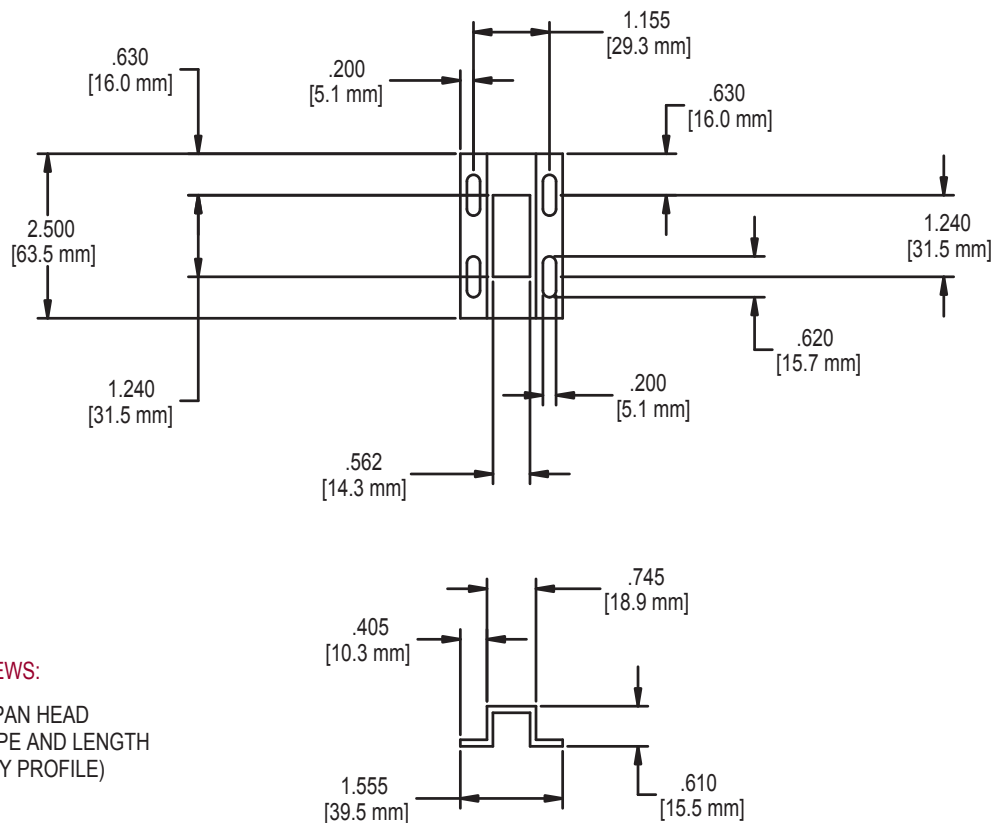

RECOMMENDED SCREWS:

(QTY 4) #10 PHILLIPS PAN HEAD
SCREWS (THREAD TYPE AND LENGTH
TO BE DETERMINED BY PROFILE)

FIG. 11 32477 & 32416 KEEPER

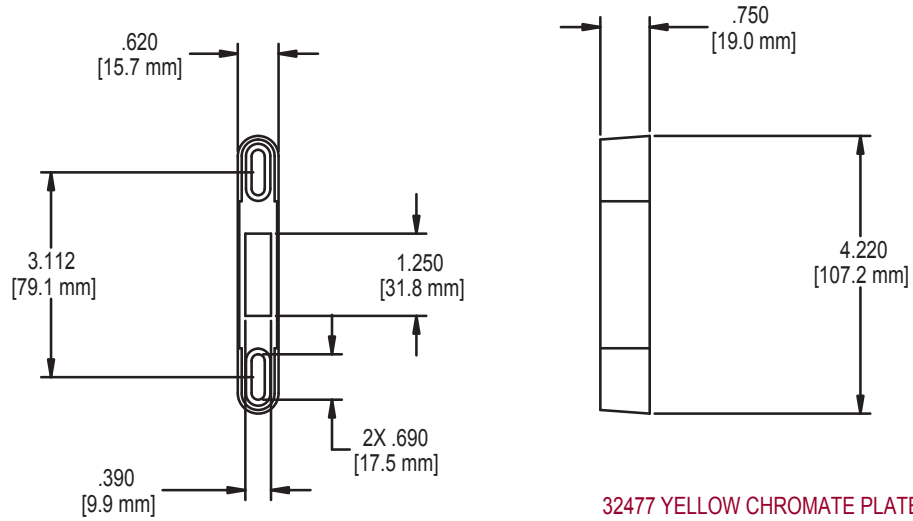

32477 YELLOW CHROMATE PLATED
32416 CLEAR CHROMATE PLATED

RECOMMENDED SCREWS: (QTY 2) #10 PHILLIPS PAN HEAD SCREWS
(THREAD TYPE AND LENGTH TO BE DETERMINED BY
PROFILE)

FIG. 12 22099 & 22065 KEEPER

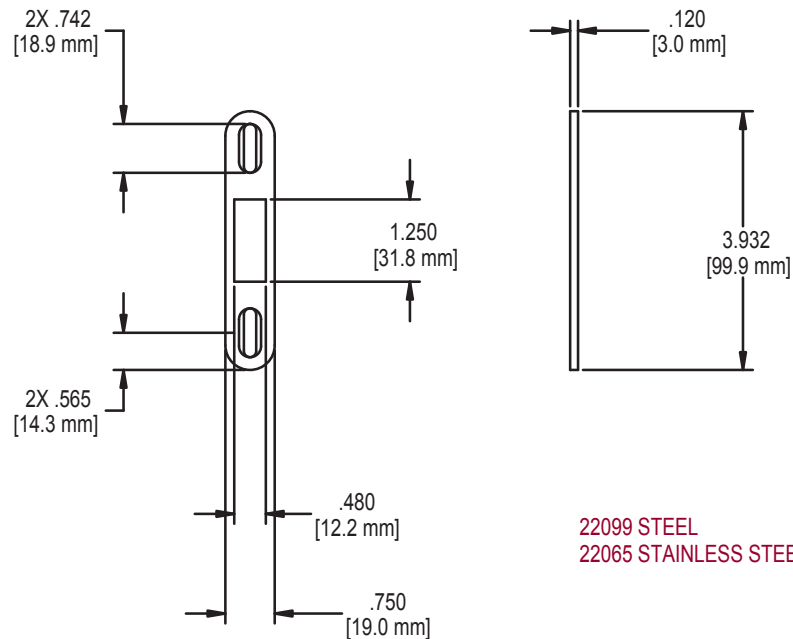

22099 STEEL
22065 STAINLESS STEEL

RECOMMENDED SCREWS: (QTY 2) #10 PHILLIPS PAN HEAD SCREWS
(THREAD TYPE AND LENGTH TO BE DETERMINED BY
PROFILE)

FIG. 13 32481 & 22063 KEEPER

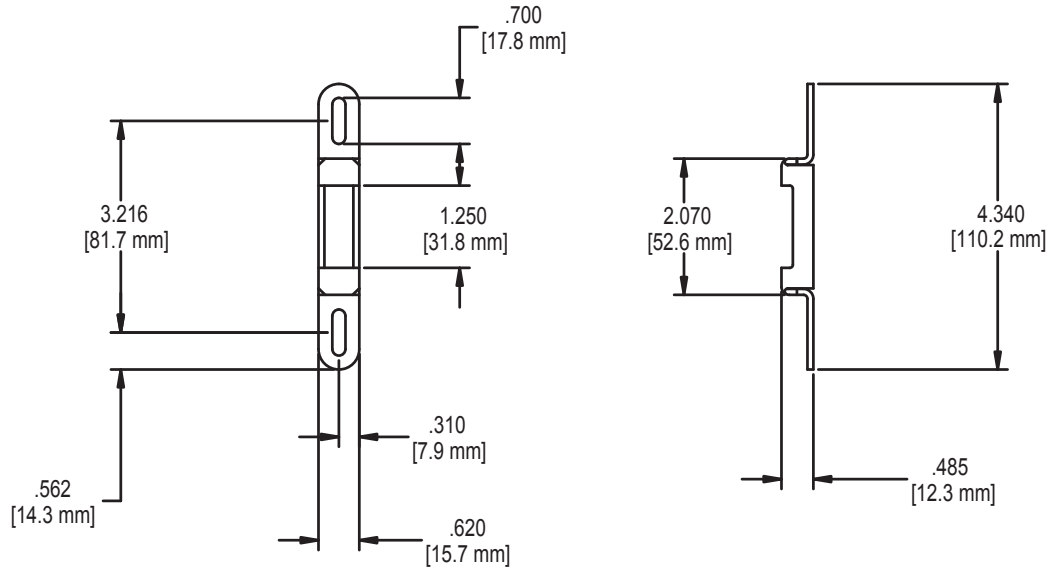

32481 YELLOW CHROMATE PLATED
22063 STAINLESS STEEL

RECOMMENDED SCREWS: (QTY 2) #10 PHILLIPS PAN HEAD SCREWS
(THREAD TYPE AND LENGTH TO BE DETERMINED BY
PROFILE)

FIG. 14 32412 & 32505 KEEPER

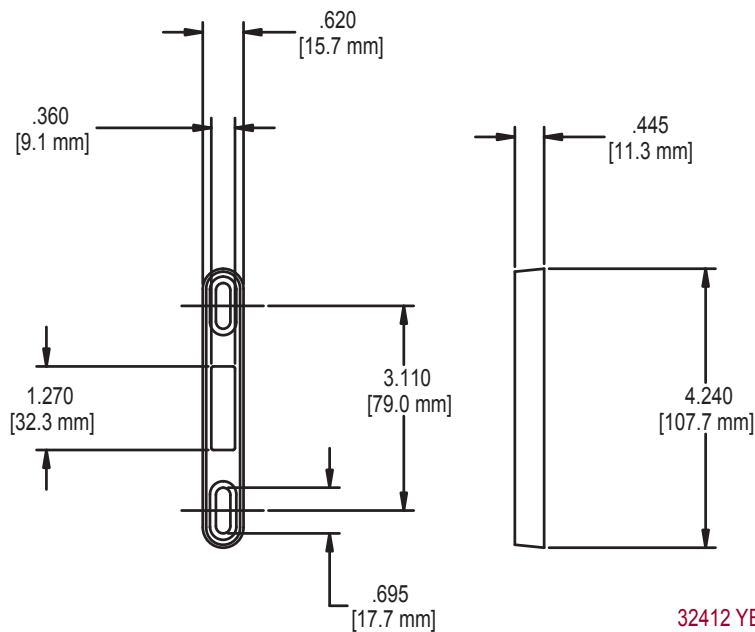

32412 YELLOW CHROMATE PLATED
32505 CLEAR CHROMATE PLATED

RECOMMENDED SCREWS: (QTY 2) #10 PHILLIPS PAN HEAD SCREWS
(THREAD TYPE AND LENGTH TO BE DETERMINED BY
PROFILE)

FIG. 15 23038 SPACER

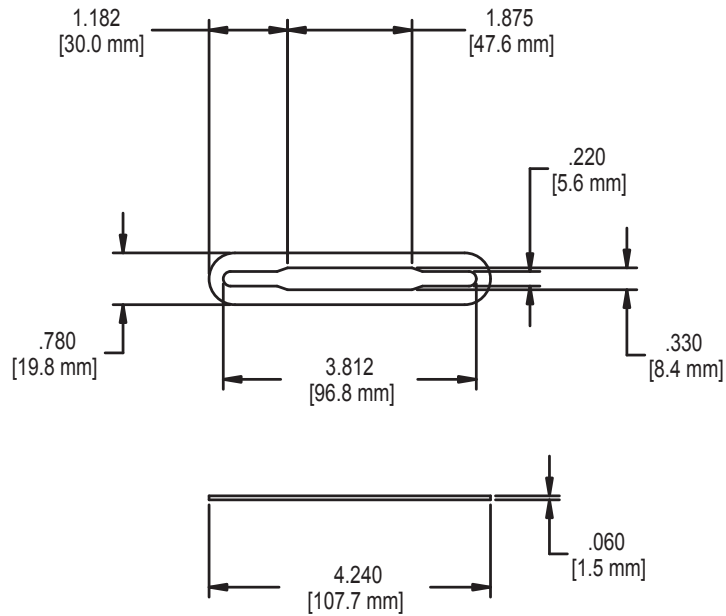
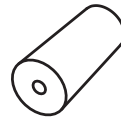
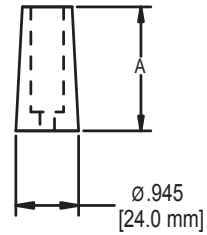

FIG. 16 22082 BUMPER



AVAILABLE BUMPER	A
I-R113-2G98	2.625
22082	2.000



RECOMMENDED SCREWS: (QTY 1) #10 PHILLIPS PAN HEAD (LENGTH AND THREAD TYPE TO BE DETERMINED BY PROFILE)

2300/2320

**MORTISE LOCKS AND
HANDLESET ACCESSORIES
(Keepers, Spacers, Adapters and
Bumpers)**